

FILL IN SPECS

DROP OR RISE	
CEMA E	
FACE LENGTH	
CAN DIAMETER	
0-3-5 DEGREE	
HEIGHT	
OPTIONAL COVERING	
FINAL OD AFTER COVERING	
QUANTITY	

CEMA E SHAFT IS: 1 7/16" DIA,
TURNED DOWN TO 1 1/4" DIA.

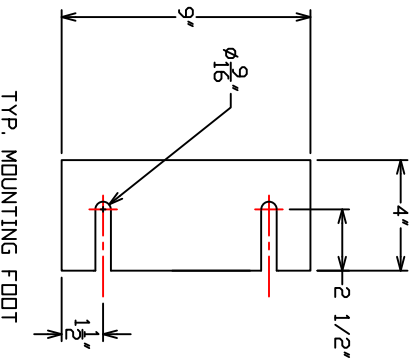

COVERS: MILLABLE URETHANE OR VULC. RUBBER

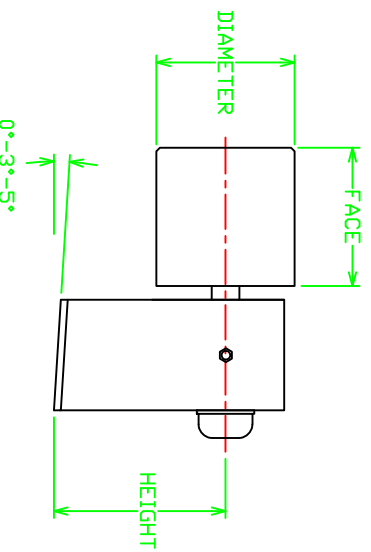

THIS IS RISE BRKT
DROPPING THE CAN.

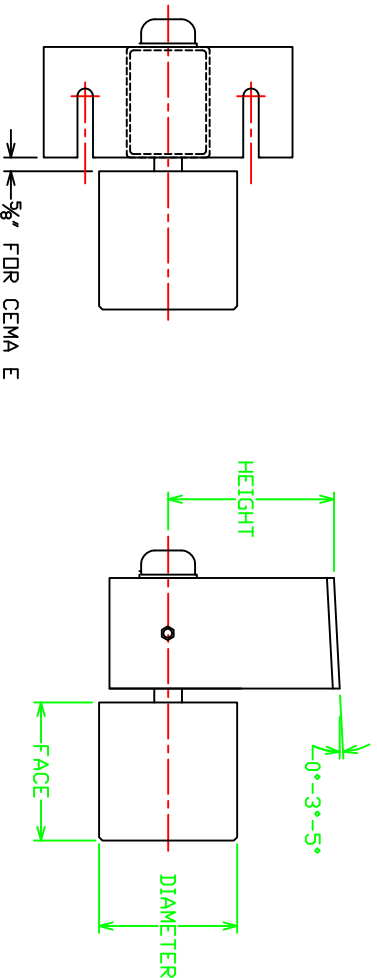

THIS IS DROP BRKT
DROPPING THE CAN.

85% OF RECESS SHOULD BE SUPPORTED

REV. NO.	DATE	REV. INDICATION	BY	DATE	CHK'D DONE	INFO
X	XXXX	XXXXX	XXX	XXX	XXX	
<p>FOR CURRENT INFORMATION CONTACT ASGCO MFG., INC. AT (610) 821-0216 www.ASGCO.com</p> <p>THE DRAWING AND THE INFORMATION THEREIN IS THE PROPERTY OF ASGCO. IT IS TO BE KEPT IN CONFIDENTIALITY AND NOT TO BE REPRODUCED OR TRANSMITTED IN ANY FORM OR BY ANY MEANS, ELECTRONIC OR MECHANICAL, INCLUDING PHOTOCOPYING, RECORDING, OR BY ANY INFORMATION STORAGE AND RETRIEVAL SYSTEM, WITHOUT THE WRITTEN PERMISSION OF ASGCO.</p>						
<p>ASGCO MANUFACTURING, INC. 300 GORDON STREET MILFORD, MA 01860 617-534-1100</p>			<p>DATE: 1/19/2014 SCALE: DNS CHECKED: XXXXX DRAWN BY: JYC/NL</p>			
<p>PROJECT: CUSTOMER & PO NUMBER</p>			<p>1 OF 1</p>			