

ARMORITE® WEAR BUTTON

Conveyor Wear Liner

ASGCO® **Armorite®** is an extremely hard, laminated bi-metallic, wear resistant composite, which has a nominal hardness of 700 BHN (63Rc) produced by combining a highly alloyed chromium-molybdenum white iron (to AS 2027 15/3 Cr/Mo) and metallurgically bonding it to a mild thick steel backing plate. The resultant bond possesses high shear strength of over 250 Mpa and will not separate.

Armorite® Wear Buttons are a circular domed shape wear part that provides maximum protection while minimizing the effects of impact. The round shape virtually eliminates any chance of a weld cracking.

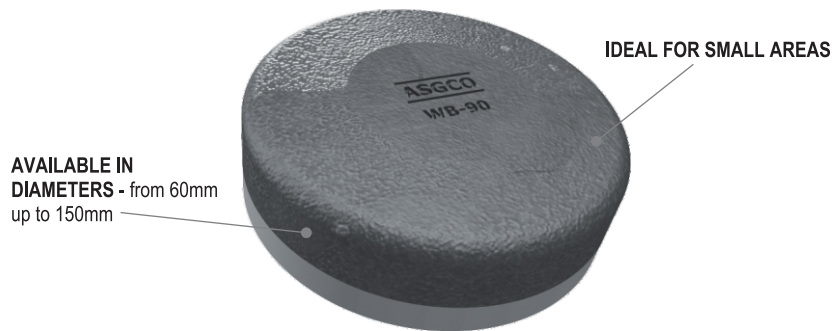

- **Ideal for smaller areas** within the conveyor system requiring wear resistant material.
- **Requires less welding time** and material than conventional wear plate.
- **Available in diameters** from 60mm up to 150mm.
- **Easy to use and install** with no pre or post heating.
- **Ideal for specific wear protection** on buckets, to conveyor transfer points and chutes
- **Great alternative** to labor intensive hard facing

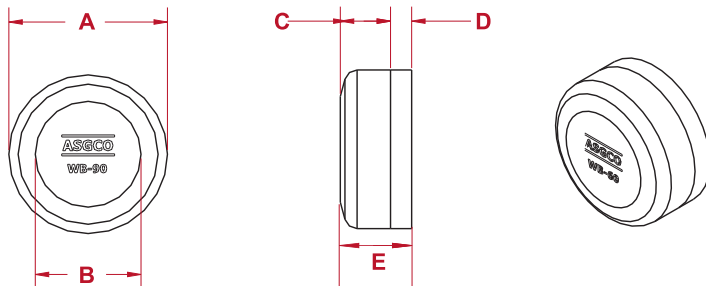

Part Number	Description	A Diameter	B Length	C Width	D Thick	E Total	Wt Lbs
ASG-AMR-WB-90	Wear Button	3-9/16"	1-3/16"	3/8"	3/8"	6/8"	3.3

Custom sizes available at customers request.
Thickness White Iron 3/4" - Thickness Base Plate 3/8"



Armorite® Product Benefits:

- Lower operating costs
- Longer Service when compared to conventional materials
- Increased production
- Improved product efficiency
- Increased equipment availability

Armorite® Product Features:

- White Iron: Modified AS2027 15/3 Cr Mo
- Vacuumed brazed and liquid nitrogen cooled to achieve a high strength joint
- Mild steel backing offers strength machinability, and impact resistance
- Can be welded in place, through-bolted, stud bolted, drilled, tapped, keyed
- Ease of fitment, very versatile

Armorite® Bond Zone Layers



Need Solutions...to improve efficiency, safety and productivity? ask... ASGCO®

www.asgco.com | 800.344.4000

© 6/2015 ASGCO® "Complete Conveyor Solutions"

